

2) MACHINE SPECIFICATIONS

MODEL	UNIT	VMC-2000G
TABLE		
Working surface	mm (inch)	2100x1200(83x47)
T-slot (size x number x pitch)	mm (inch)	20x7x160(0.8x7x6.3)
Max. table load	kg (lbs)	2500 (5500)
TRAVEL		
Longitudinal travel (X-axis)	mm (inch)	2000 (78.8)
Cross travel (Y-axis)	mm (inch)	1200 (47)
Vertical travel (Z-axis)	mm (inch)	500 (20)
Distance of spindle end to table	mm (inch)	500-1000(19.7-39.4)
Distance of spindle-center to column	mm (inch)	302 (11.9)
SPINDLE		
Spindle nose taper		# 50
Spindle speed (gear type)	r.p.m.	50-4000
FEED		
Cutting feedrate	mm/min (ipm)	1-7000(0.04-275)
Rapid traverse (X, Y axis)	mm/min (ipm)	10000 (393)
Rapid traverse (Z axis)	mm/min (ipm)	10000 (393)
ATC		
Tool storage capacity	pcs.	30 (24)
Max. tool weight	kg (lbs)	15 (33)
Max. tool size (diameter x length)	mm (inch)	140x300(5.5x12)
Tool selection		Random
Tool change time (approx.)	sec.	8
Tool shank		BT-50 or CAT-50
Pull stud bolt		R50T.1 or CAT.50
MOTORS		
Spindle drive motor (30mm rating)	kw (HP)	15(20)
X, Y, Z axis drive motor (A.C.)	kw (HP)	MITSUBISHI XY-axis HA300, Z-axis HA200 FANUC XY-axis 305, Z-axis 204
ACCURACY		
Positioning	mm (inch)	±0.01/300 (±0.0004/12)
Repeatability	mm (inch)	±0.01 (±0.0004)
Accumulation in full travel	mm (inch)	±0.015 (=0.0006)
REQUIRED AIR PRESSURE	kg/cm ² (psi)	5 (70)
ELECTRIC POWER CONSUMPTION	KVA	40
MACHINE WEIGHT	kg (lbs)	17000 (37400)
FLOOR SPACE	mm (inch)	5650x3860(223x152)
COOLANT TANK CAPACITY	ℓ	160
COOLANT PUMP MOTOR	HP	1/2
LUBRICATION TANK CAPACITY	ℓ	2
LUBRICATION PUMP MOTOR	w	3
HIGH PRESSURE GEAR PUMP	8cc/rec (1500rpm-12ℓ/min), 20kg/cm ² (1800rpm-14.4ℓ/min)	

1. SPECIFICATIONS
 1) MACHINE DIMENSIONS
 1.1) External Dimensions

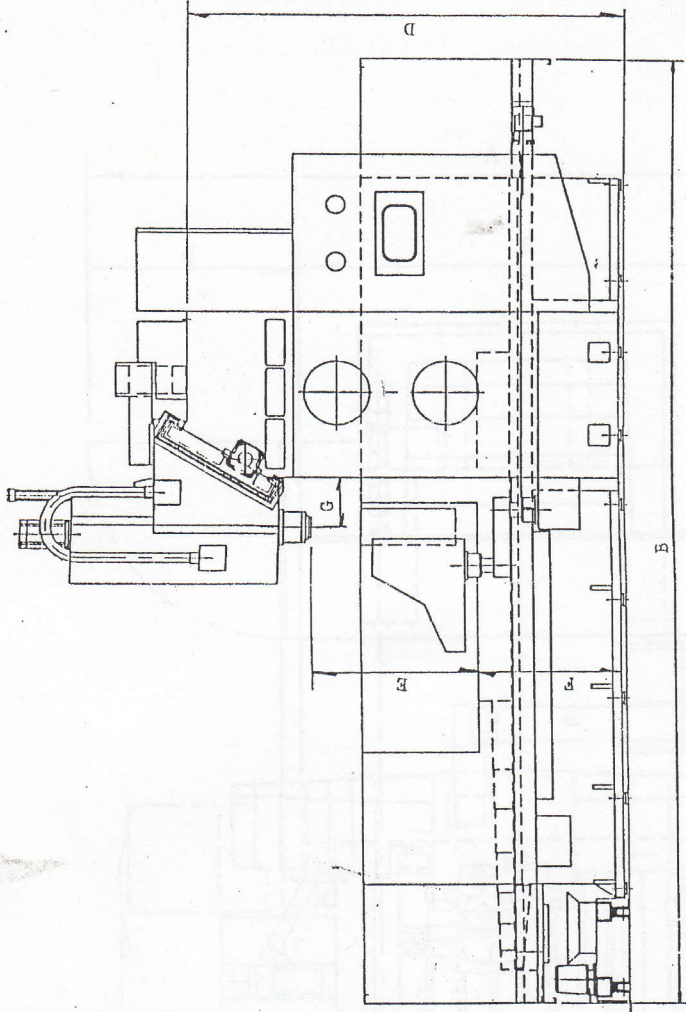
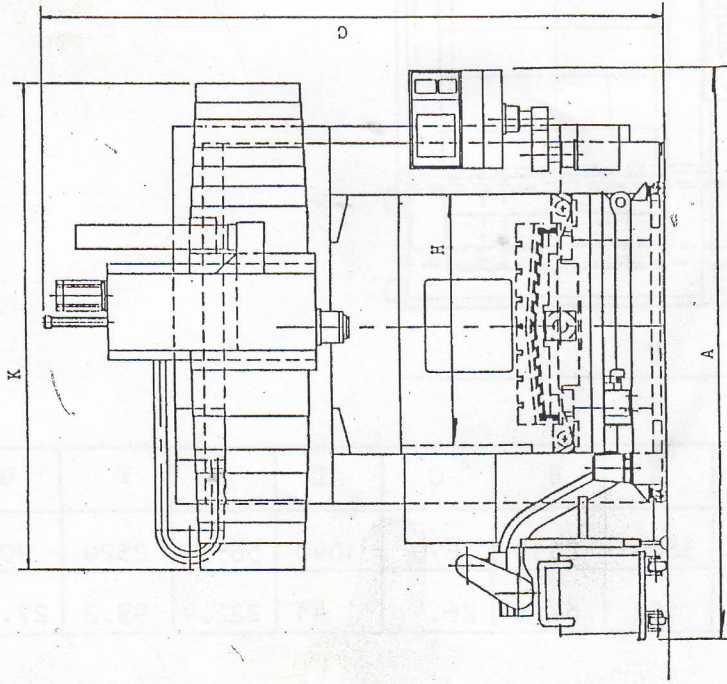

Model	Unit	A	B	C	D	E	F	G	H	K
		mm	3230	5650	3580	2540	500-1000	840	302	1480
VNC-2000	inch	127	222.4	141	100	19.7- 39.3	33	11.9	58.3	118